

## Distribution Fuse Cutout Double Insulator Design

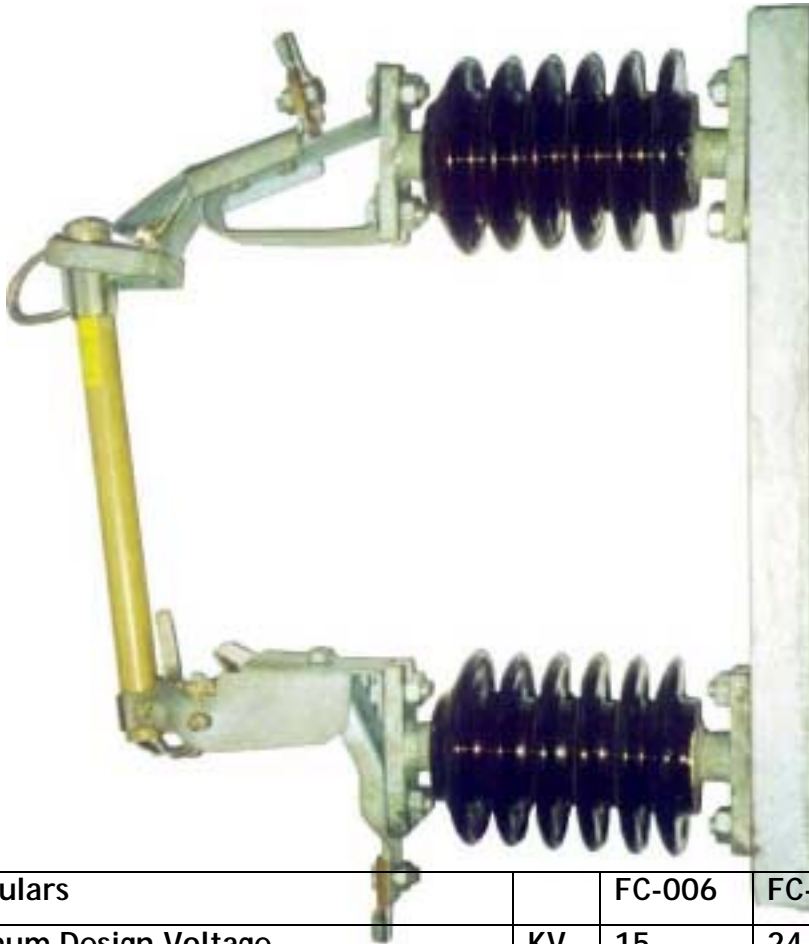

Particulars		FC-006	FC-005	FC-004
Maximum Design Voltage	KV	15	24	36
System voltage	KV	11	22	33
Continous current rating	A	100	100	200
Withstand voltage				
Power frequency - Dry	KV	35	75	95
Power frequency - Wet	KV	30	65	85
Basic Insulation level	KV	125	150	200
Creepage distance to earth ( min )	MM	280	450	650
Rated breaking capacity ( Sym )	Ka	8	8	4
Rated breaking capacity ( Asym )	Ka	12	12	6

Other sizes & ratings available on request  
All dimensions in mm \* We reserve the right to change design & construction without prior notice

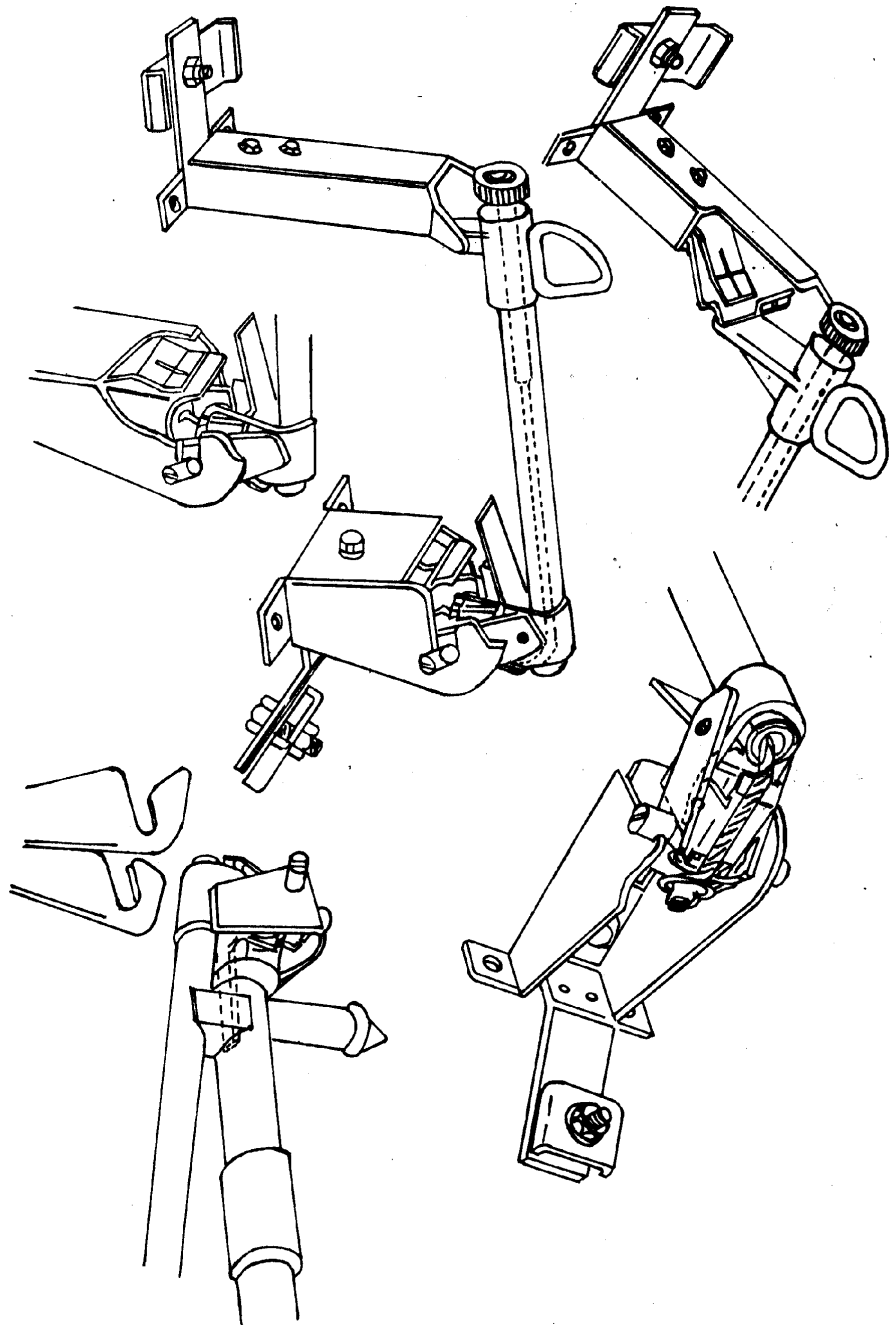

Other sizes & ratings available on request  
All dimensions in mm \* We reserve the right to change design & construction without prior notice