

# Pole line hardware's Anchor Rod (Oval eye)

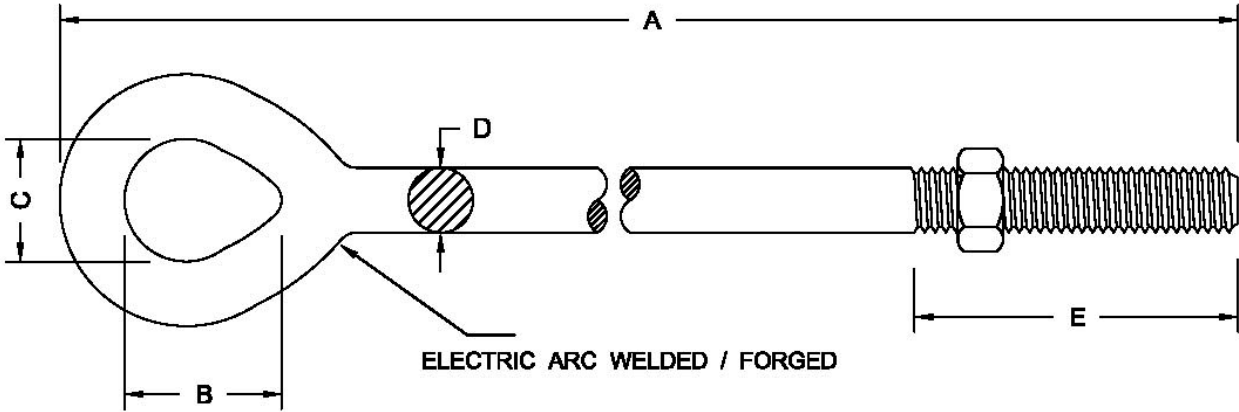

Nuts may be hex or square  
And to be specified while ordering

Threads cut or rolled and to  
be specified while ordering

Catalog	Diameter	B	C	E	Washer	MFL LBS	Thimble
AROE-01	5/8	2	1-1/2	3-1/2	4 X 4 X 3/16	16000	1/4-3/8
AROE-02	3/4	2	1-1/2	3-1/2	4 X 4 X 1/4	23000	3/8-1/2
AROE-03	7/8	2	1-1/2	3-1/2	4 X 4 X 3/8	30000	1/2-5/8

Anchor rod supplied complete with one square nut unless otherwise specified

Please specify welded or forged by adding w or f to the suffix

Washer and thimble can be supplied at additional cost.

The recommended size of washer and thimble as stated above

All ferrous parts hot dip galvanized to ASTM A153

Oval eye anchor rods confirm to requirements of ANSI C135.2

Other sizes available on request  
All dimensions in inches \* We reserve the right to change design & construction without prior notice