

## Pole line hardware's Washer Spring / Round

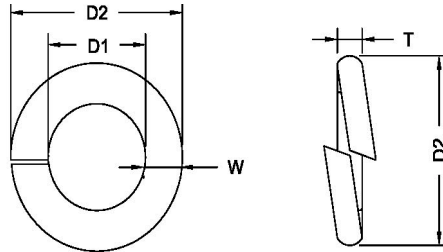

CATALOG	D1	D2	W	T	WT/1000 PCs
M08	8.2	14.8	3.0	2.0	1.60
M10	10.2	18.1	3.5	2.2	2.53
M12	12.2	21.1	4.0	2.5	3.82
M16	16.2	27.4	5.0	3.5	8.91
M20	20.2	33.6	6.0	4.0	15.2
M24	24.5	40.0	7.0	5.0	26.2

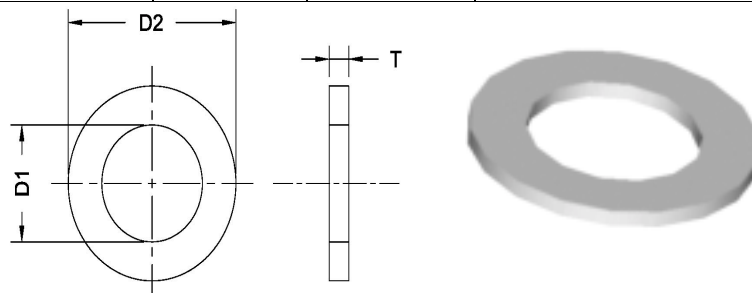

CATALOG	D1		D2		T	
	min	max	min	max	min	max
M08	6.6	7.0	11.7	12.5	1.3	1.9
M10	9.0	9.4	16.2	17.0	1.3	1.9
M12	11.0	11.5	20.2	21.0	1.7	2.3
M16	18.0	18.5	29.2	30.0	2.4	3.6
M18	20.0	20.6	32.8	34.0	2.4	3.6
M20	22.0	22.6	35.8	37.0	2.4	3.6
M22	24.0	24.6	37.8	39.0	2.4	3.6
M24	26.6	28.0	42.8	44.0	3.4	4.6

All ferrous parts are hot dip galvanized to ASTM A153 / BS 729

Other sizes available on request

All dimensions in mm\* We reserve the right to change design & construction without prior notice